

Product introduction

PIR motion sensor light is high smart technology, the appearance of the product is made of aluminum alloy and plastic, Using the advanced LED lighting technology and motion sensing technology, the product is beautiful, atmospheric and practical create a warm and happy intelligent life for you.

Product feature

- Using the high quality LEDs, the lighting is soft and comfortable.
- PIR motion sensor switch, people come to the sensor range, When people left away, it will turn off after 18s.
- Easy to install, no screws are required, It can be directly attached to the magnet for adsorption.
- three working modes: OFF/ON/AUTO Switch.

Application

Bedroom. stair. cabinet. drawer. corridor.

Usage

- Using the rubber metal plate to adsorp the built-in magnet of the light.
Tear off the 3M adhesive tape and paste the lamp on the position where you want to install.
- Choose the ON dial Switch, the light will turns on forever
- Choose the AUTO dial Switch, the light will work automatic. Sensor mode, when people come, the light will turn on, and left, the light will turn off
- Choose the OFF dial Switch, the light will turn off.
- Automatic induction : if the light sensor detects the movement of human body the product will not turn on even when there is the movement of human body.

Product parameter

Induction model: PIR motion sensor
Lithium battery: 300MA
Current: 100MA
Power: 0.37W
Luminance: 35LM
Color rendering index: >80
Delay time: 18s(±2s)
Lamp color: white/warm white
Detection distance: >3M
Detection angle: 120°
Using temperature: -20°C ~ 50°C
Weight: 55g

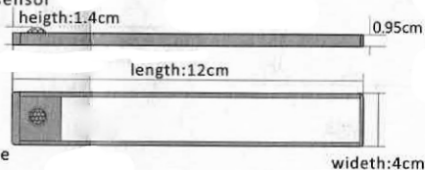

Induction model: PIR motion sensor
Lithium battery: 900MA
Current: 340MA
Power: 1.4W
Luminance: 90LM
Color rendering index: >80
Delay time: 18s(±2s)
Lamp color: white/warm white
Detection distance: >3M
Detection angle: 120°
Using temperature: -20°C ~ 50°C
Weight: 110g

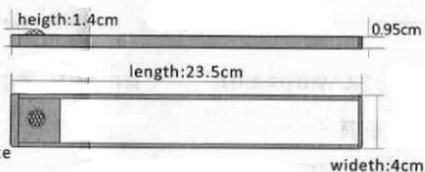

Induction model: PIR motion sensor

Lithium battery: 1500MA

Current: 750MA

Power: 3W

Luminance: 170LM

Color rendering index: >80

Delay time: 18s(±2s)

Lamp color: white/warm white

Detection distance: >3M

Detection angle: 120°

Using temperature: -20°C ~ 50°C

Weight: 183g

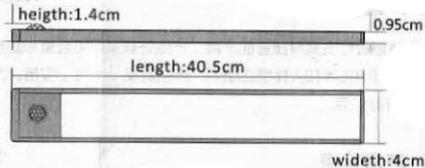

Induction model: PIR motion sensor

Lithium battery: 2200MA

Current: 800MA

Power: 3.2W

Luminance: 220LM

Color rendering index: >80

Delay time: 18s(±2s)

Lamp color: white/warm white

Detection distance: >3M

Detection angle: 120°

Using temperature: -20°C ~ 50°C

Weight: 245g

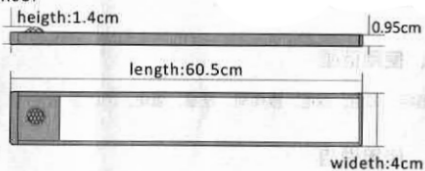

Product diagram

Diagram A
Sensing diagram

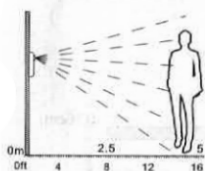

FIG.A

Diagram B
Product structure

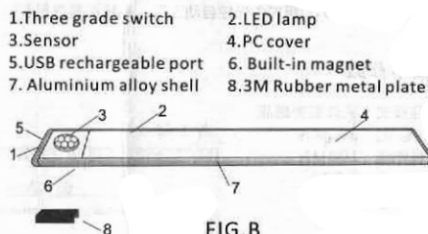
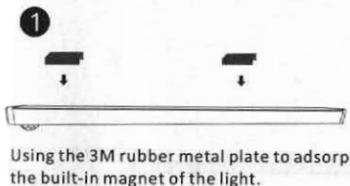
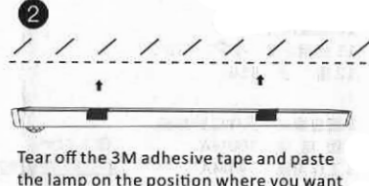

FIG.B

Product installation drawing



Using the 3M rubber metal plate to adsorp the built-in magnet of the light.



Tear off the 3M adhesive tape and paste the lamp on the position where you want to install.

Warning

1. This product is not waterproof, please do not install it in any place with moist and rainy.
2. Do not install it in the place with high humidity and strong light and air vents to avoid fault triggering.
3. When the light is diming and flickering, please charge the product in time.
4. When the product fails during the warranty period, do not dismantile the product privately, otherwise it will not be guaranteed.